



TOP TECH

# ALTOCUT-CK Series Precision Cutting Machine



*Perfect Surface.  
Always*

## CK200B (Auto)/ CK200M (Manual)

- The safety sensor for the top cover confirms the spindle will stop automatically when the top cover is opened during operation.
- The front limit sensor and the back limit sensor control the cutting distance.
- LED light enhances the observation of the cutting process and illuminates the cutting space.
- Magnetic water spray hose easily cleans the cutting chamber and vise.
- A storable design for the coolant tank saves the space.

## Introduction & Feature

- Application range: automotive, aerospace, manufacturing industry, and research & education institution
- Suitable for steel, iron, copper, titanium, aluminum, ceramic, spark plug, sensor, fastener and all small workpiece

### Safety sensor for the top cover

The safety sensor for the top cover confirms the spindle will stop automatically when the top cover is opened during operation.

### Magnetic interlock system (Optional)

After the spindle is started, the top cover can't be opened during the operation. Wait for 10 seconds after the spindle is stopped, the top cover can be opened.

### Intuitive panel for convenient operation

Intuitive panel with high recognition graphics is easy to understand. It decreases operating time significantly.

### LED light

LED light enhances the observation of the cutting process and illuminates the cutting space.

### Feeding clutch (CK200B )/ Hand wheel

Feeding clutch switches manual mode and auto mode quickly. Feeding rate is controlled by the hand wheel, the operation is easy.



### Front limit sensor and back limit sensor

The front limit sensor and the back limit sensor control the travel distance for feeding.

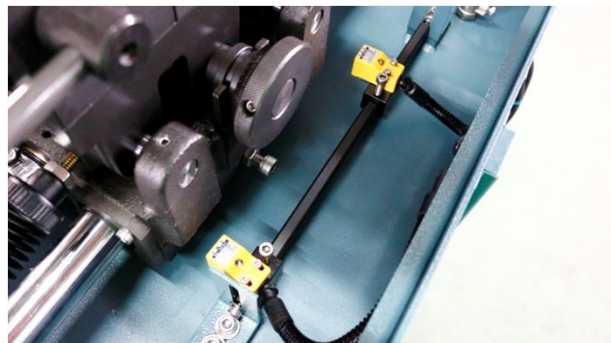

### Magnetic water spray hose

Magnetic water spray hose easily cleans the cutting chamber and vise.

### Storable design for the coolant tank

A storable design for the coolant tank increases the space utilization.



### Variable spindle rotation speed (Optional)

Frequency transformer for variable spindle rotation speed (plus or minus 50%)

## Introduction & Feature

### Horizontal movement vise (Standard)

Left and right vise can each be moved 25mm in horizontal direction (Y-axis)

Right vise can be moved 75mm in X-axis (feeding)

The maximum opening of the vise is 60mm (Please refer to the appendix 1 for the maximum cutting capacity)

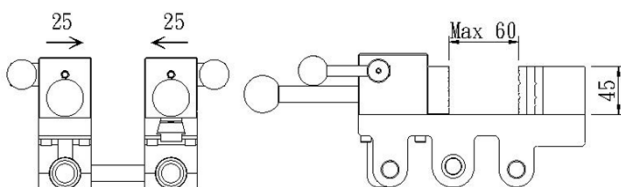
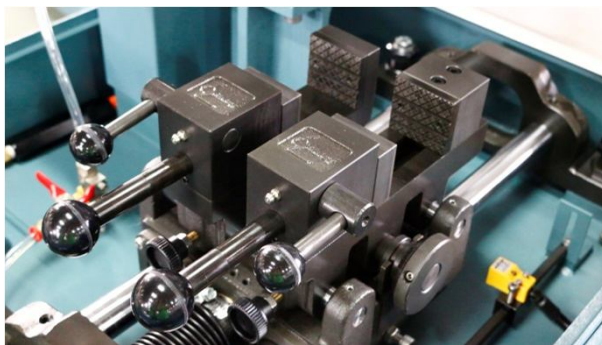

### Separated horizontal movement platform (Optional)

Left and right platform can each be moved 25mm in horizontal direction (Y-axis)

The maximum opening of the vise is 70mm (Please refer to the appendix 2 for the maximum cutting capacity)

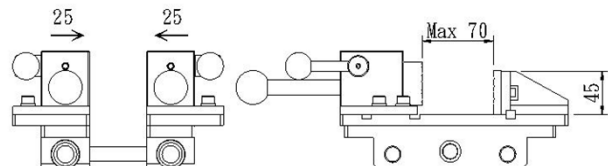
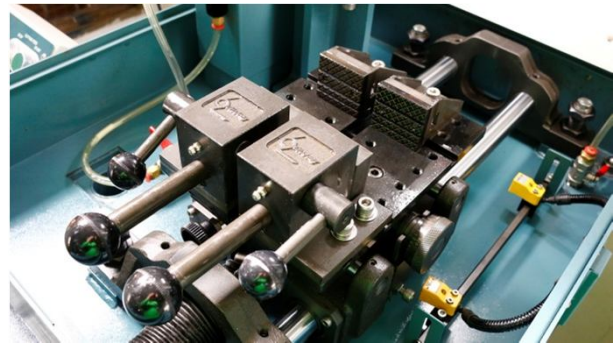

### Magnetic filtration recirculation coolant system (optional)

Equipped with the powerful magnetic separator, it can filter the iron debris in the cutting coolant, which increases the lifespan of the cutting coolant at the same time.

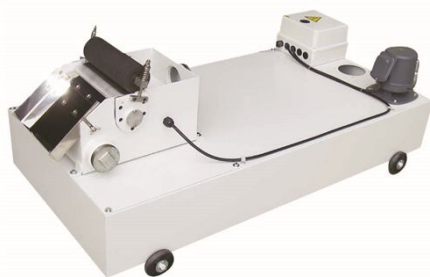

Order No.	Specification
CK-003	120L
CK-003-1	160L
CK-003-2	200L

## Introduction & Feature

### Dual overload protection (optional)

First protection: When the current is over AL1 (the first overload setting value), the feeding set will stop for 3 seconds. If the current doesn't decrease, the feeding set will return for 3 seconds (seconds can be set). If the current doesn't still decrease, the spindle set will stop rotating immediately. If the current decrease, the cutting will be continued.

Second protection: When the current is over AL2 (the second overload setting value), the feeding set will be forced to return and the spindle will stop rotating.

#### First protection

When current  $\geq$  AL1: Stop feeding for 3 seconds

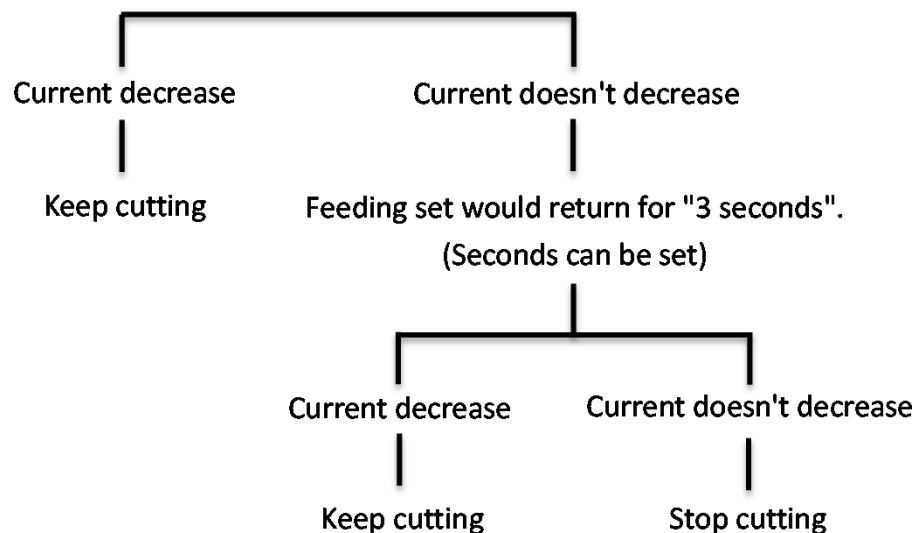

#### Second protection

When current  $\geq$  AL2: **Stop cutting.**

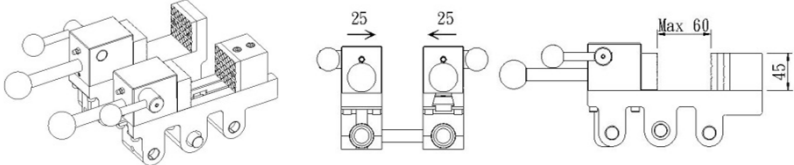

## Specification

Model		CK200B (Auto)		
Travel Distance (mm)		200		
Motor Power (HP)		1	2	3
Total Watt (W)		900	1650	2400
Idling Noise Level (dB)		70~72	70~74	70~75
Cutting Ability (mm)		Ø35	Ø50	Ø60
Cut-off Blade (mm)		Ø230 x 31.75	Ø255 x Ø31.75	
Flange Diameter (mm)		Ø60		Ø85
Feeding method	Auto:	Home point return after cutting		
	Manual:	Button & Hand wheel control		
Feeding Rate (mm/min)		Standard : 10~150, Option : 5~75 (Low feeding rate can be customized)		
Rotational Speed (rpm)		3000(60Hz) or 2500(50Hz)		
Cutting Vise (Standard)		Horizontal movement vise 		
Vise Dimension (mm)		Max. 60*45 (Opening Width x Height)		
Vise Movement in Y-axis (mm)		Separated movement: 25mm		
Coolant Pump		1/8HP 3Ø		
Coolant Tank Capacity (L)		50		
Coolant Tank Dimension (mm)		370 x 550 x 600 (WxDxH)		
Coolant Tank Weight (kg)		40		
Machine Dimension (mm)		830 x 930 x 1320 (WxDxH)		
Machine Weight (kg)		226	230	250
Power Supply		AC220V/380V 3Ø AC200V/415V/440V (Special voltage can be customized)		
Standard Accessories		Wrench 2 sets, Cut-off wheel 2 pcs, Cutting coolant 3L		

## Specification

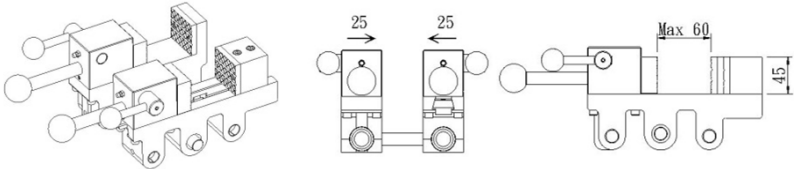
Model	CK200M (Manual)		
Travel Distance (mm)	200		
Motor Power (HP)	1	2	3
Total Watt (W)	850	1600	2350
Idling Noise Level (dB)	70~72	70~74	70~75
Cutting Ability (mm)	Ø35	Ø50	Ø60
Cut-off Blade (mm)	Ø230 x 31.75	Ø255 x Ø31.75	
Flange Diameter (mm)	Ø60		Ø85
Feeding Rate (mm/min)	Manual: Hand wheel control		
Rotational Speed (rpm)	3000(60Hz) or 2500(50Hz)		
Cutting Vise (Standard)	Horizontal movement vise 		
Vise Dimension (mm)	Max. 60*45 (Opening Width x Height)		
Vise Movement in Y-axis (mm)	Separated movement: 25mm		
Coolant Pump	1/8HP 3Ø		
Coolant Tank Capacity (L)	50		
Coolant Tank Dimension (mm)	370 x 550 x 600 (WxDxH)		
Coolant Tank Weight (kg)	40		
Machine Dimension (mm)	830 x 930 x 1320 (WxDxH)		
Machine Weight (kg)	212	218	230
Power Supply	AC220V/380V 3Ø AC200V/415V/440V (Special voltage can be customized)		
Standard Accessories	Wrench 2 sets, Cut-off wheel 2 pcs, Cutting coolant 3L		

## Parameters

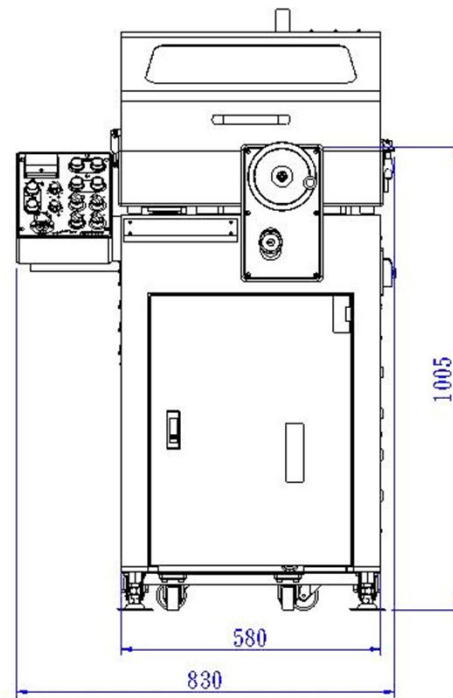
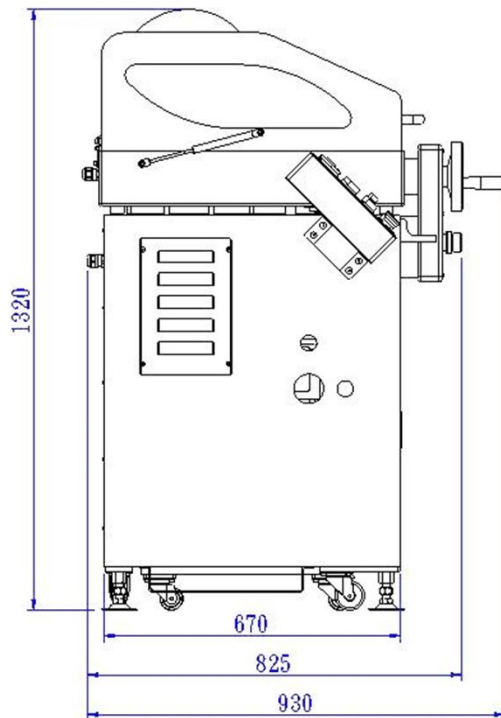
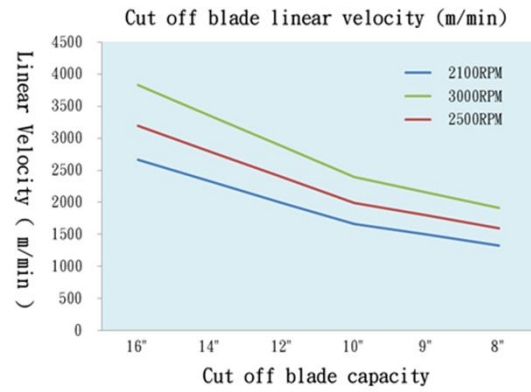
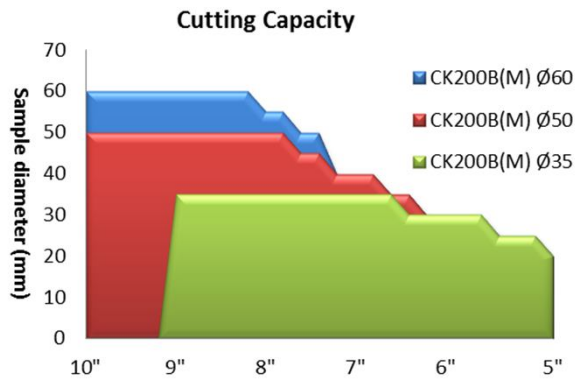

1. The parameters are for reference only.
2. The actual cutting range will be affected by the cut-off wheel, material, rotational speed, feeding rate, vise, and other factors.

## Appendix 1 -Horizontal movement vise

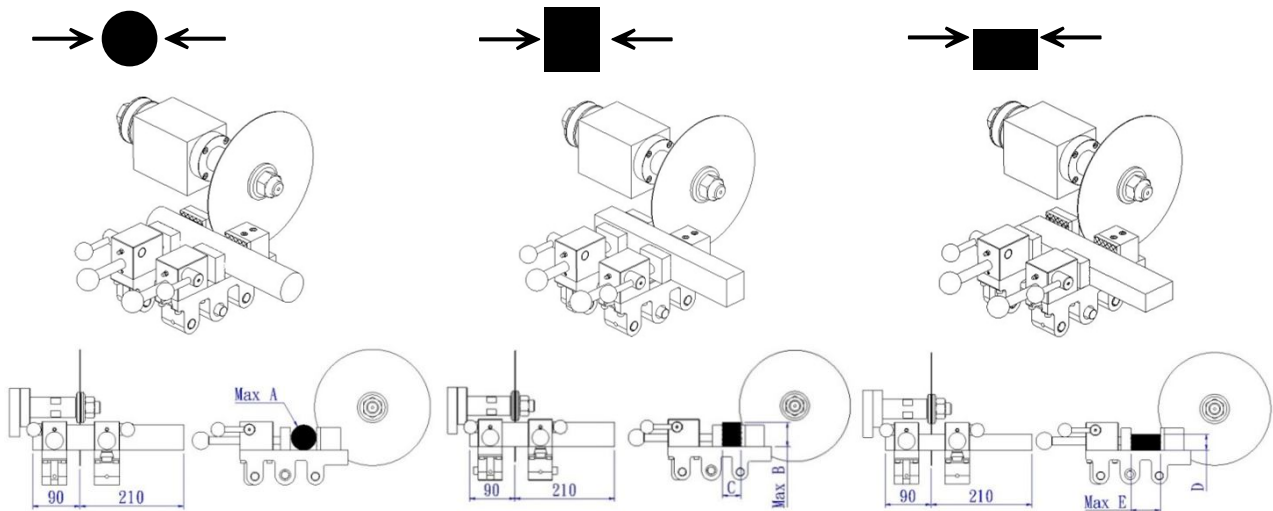

Model	●		■		■	
	A(mm)	A cutting area (mm <sup>2</sup> )	B(mm)	B*C	E(mm)	E*D
CK200B(M) Ø35	Ø35	961.625	35	35*27.5	60	60*16.02
CK200B(M) Ø50	Ø50	1962.5	50	50*39.25	60	60*32.7
CK200B(M) Ø60	Ø60	2826	60	60*47.1	60	60*47.1

Square area surface calculation method:

The maximum height is B, the maximum width is E.  $B \times C$  or  $E \times D \leq A$  surface area.

Material application: Alloy tool steel SKS, SKD, SKT, SUP as heat treatment mechanical metal components, ordinary carbon steel, mechanical structure steel S-C series, tool steel SK series, and soft steel SS series.

Surface area can be cut in according to its degree of heat treatment

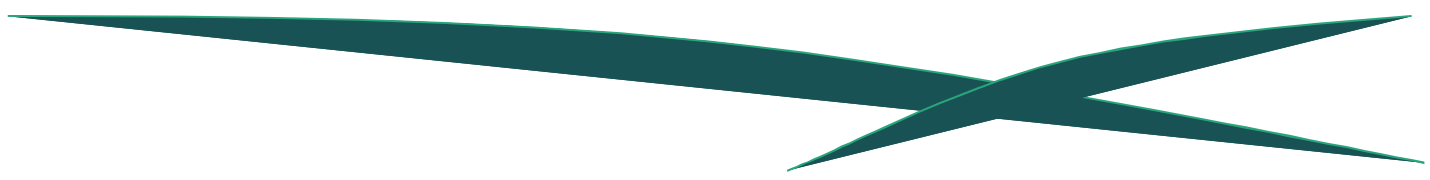



**Appendix 2- Separated horizontal movement platform**

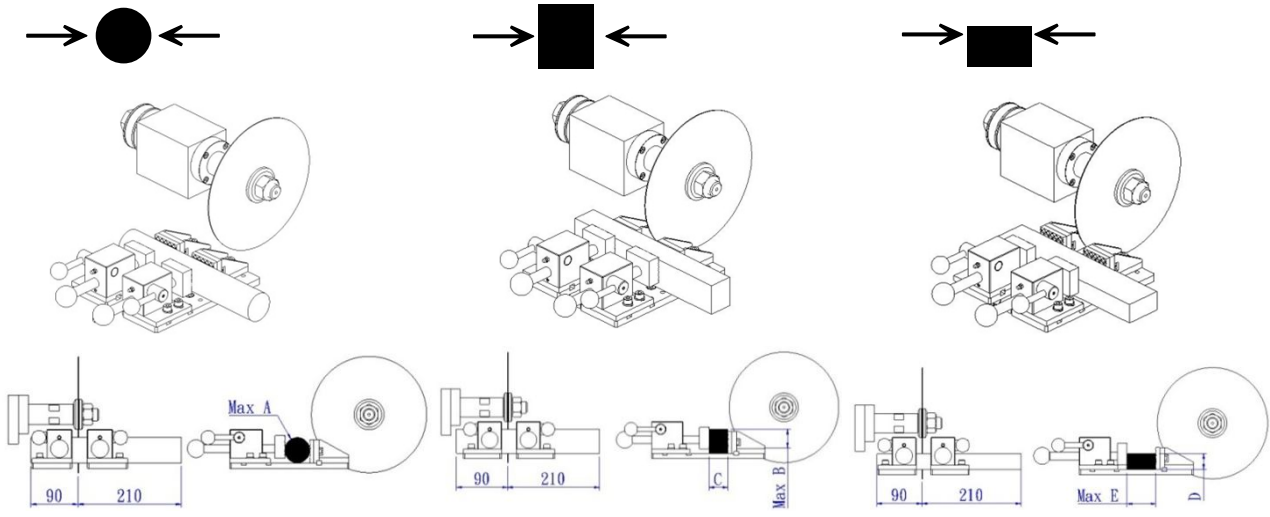

Model	●		■		■	
	A(mm)	A cutting area (mm <sup>2</sup> )	B(mm)	B*C	E(mm)	E*D
CK200B(M) Ø35	Ø35	961.625	35	35*27.5	70	70*13.73
CK200B(M) Ø50	Ø50	1962.5	50	50*39.25	70	70*28.03
CK200B(M) Ø60	Ø60	2826	60	60*47.1	70	70*40.37

Square area surface calculation method:  
 The maximum height is B, the maximum width is E.  $B \times C$  or  $E \times D \leq A$  surface area.  
 Material application: Alloy tool steel SKS, SKD, SKT, SUP as heat treatment mechanical metal components, ordinary carbon steel, mechanical structure steel S-C series, tool steel SK series, and soft steel SS series.  
 Surface area can be cut in according to its degree of heat treatment

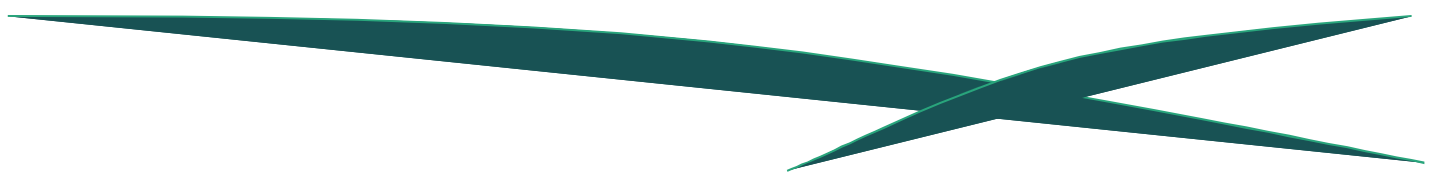

## Appendix 3- Cutting Chamber Dimension

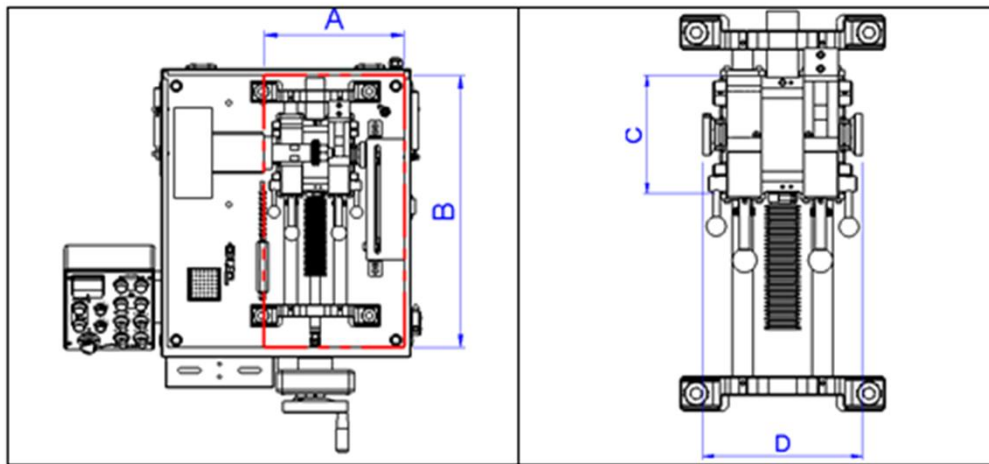

Model	A(mm)	B(mm)	C(mm)	D(mm)
CK200B(M) Ø35	300	600	235	170
CK200B(M) Ø50	300	600	235	170
CK200B(M) Ø60	300	600	235	170



## Consumables (option)

### Cut-off wheel



Order No.	Size	Dia. x Arbor Dia. x Thickness (mm)	Package (pcs/box)
For cutting of heat treated steel-alloy tool steel SKS, SKD, SKT, SK3, SUP, S45C, SCM415, SNCM439 HV495~710 (HRC50~60)			
S02A0101	9"	Ø230xØ31.75x1.0	10
S02A0202	10"	Ø255xØ31.75x1.2	10
For cutting of non-heat treated steel Carbon Steel, Stainless Steel, S-C Series Tool Steel, SK Series, SS Series Mild Steel HV380~495 (HRC40 ~ 50)			
S02B0101	9"	Ø230xØ31.75x1.0	10
S02B0202	10"	Ø255xØ31.75x1.2	10
For cutting of hard heat treated steel Special Alloy Steel, SKD, SKH, SKS3, SCM415, SACM , SNCM439 HV670~780 (HRC58 ~ 64)			
S02C0101	9"	Ø230xØ31.75x1.0	10
S02C0202	10"	Ø255xØ31.75x1.2	10
For cutting of cast iron FC and forged cast iron Cotton Series, It is more resistant to burst than other kinds of cut-off wheel HV400~780 (HRC40~63)			
S02D0101	9"	Ø230xØ31.75x1.0	10
S02D0202	10"	Ø255xØ31.75x1.2	10
For cutting of non-ferrous metal HV45~196 (HRB10~93)			
S02E0101	9"	Ø230xØ31.75x1.0	10
S02E0202	10"	Ø255xØ31.75x1.2	10
For cutting of bakelite, plastic, resin, mounting specimen, sapphire, tungsten steel, aluminum, copper, glass, and ceramic (aluminum oxide ceramic, zirconium oxide ceramic)			
S02F0101	9"	Ø230xØ31.75x1.0	10
S02F0202	10"	Ø255xØ31.75x1.2	10

### Cutting Coolant



Order No.	Coolant	Package/ Capacity
S01001	Oily, Emulsion(Blue Bottle Cap)	20L
S01002	Oily, Emulsion(Blue Bottle Cap)	1L

## Top Tech distributors

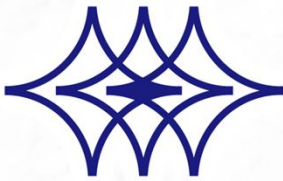

**TOP TECH**



**TOP TECH MACHINES CO.,LTD**

No.6-3,Siyuan Rd.,Dali,Taichung,412 Taiwan

TEL: +886-4-2406-3799 FAX:+886-4-2406-0960

E-mail:top@toptech.tw <http://www.toptech.tw>

Agent

We reserve the right to change design without notice.

**NO. EB1-BM01**